

# BRONZE FLANGE DIMENSIONS

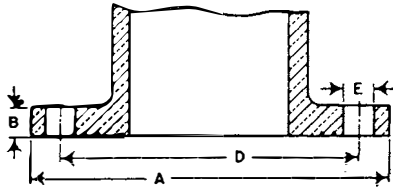

Class 150 and Class 300 Bronze

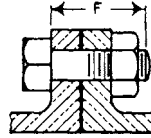

Length of Machine Bolt

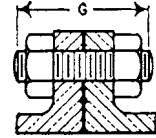

Length of Stud Bolt

## CLASS 150 BRONZE FLANGES

Dimensions in Inches

Nominal Pipe Size	Flanges		Drilling		Bolting		Length of Machine Bolts F	Length of Stud Bolts with 2 Nuts G
	Flange Diameter A	Flange Thickness B	Diameter of Bolt Circle D	Diameter of Bolt Holes E	Number of Bolts	Diameter of Bolts		
1/2	3 1/2	5/16	2 3/8	5/8	4	1/2	1 1/4	1 7/8
3/4	3 7/8	11/32	2 3/4	5/8	4	1/2	1 1/2	1 7/8
1	4 1/4	3/8	3 1/8	5/8	4	1/2	1 1/2	2
1 1/4	4 5/8	13/32	3 1/2	5/8	4	1/2	1 1/2	2
1 1/2	5	7/16	3 7/8	5/8	4	1/2	1 1/2	2 1/8
2	6	1/2	4 3/4	3/4	4	5/8	1 3/4	2 1/2
2 1/2	7	9/16	5 1/2	3/4	4	5/8	2	2 5/8
3	7 1/2	5/8	6	3/4	4	5/8	2	2 3/4
3 1/2	8 1/2	11/16	7	3/4	8	5/8	2 1/4	2 7/8
4	9	11/16	7 1/2	3/4	8	5/8	2 1/4	2 7/8
5	10	3/4	8 1/2	7/8	8	3/4	2 1/2	3 1/4
6	11	13/16	9 1/2	7/8	8	3/4	2 1/2	3 3/8
8	13 1/2	15/16	11 3/4	7/8	8	3/4	2 3/4	3 5/8
10	16	1	14 1/4	1	12	7/8	3 1/4	4 1/8
12	19	1 1/16	17	1	12	7/8	3 1/4	4 1/4

## CLASS 300 BRONZE FLANGES

Nominal Pipe Size	Flanges		Drilling		Bolting		Length of Machine Bolts F	Length of Stud Bolts with 2 Nuts G
	Flange Diameter A	Flange Thickness B	Diameter of Bolt Circle D	Diameter of Bolt Holes E	Number of Bolts	Diameter of Bolts		
1/2	3 3/4	1/2	2 5/8	5/8	4	1/2	1 3/4	2 1/4
3/4	4 5/8	17/32	3 1/4	3/4	4	5/8	2	2 1/2
1	4 7/8	19/32	3 1/2	3/4	4	5/8	2	2 5/8
1 1/4	5 1/4	5/8	3 7/8	3/4	4	5/8	2	2 3/4
1 1/2	6 1/8	11/16	4 1/2	7/8	4	3/4	2 1/4	3 1/8
2	6 1/2	3/4	5	3/4	8	5/8	2 1/4	3
2 1/2	7 1/2	13/16	5 7/8	7/8	8	3/4	2 1/2	3 3/8
3	8 1/4	29/32	6 5/8	7/8	8	3/4	2 3/4	3 1/2
3 1/2	9	31/32	7 1/4	7/8	8	3/4	3	3 5/8
4	10	1 1/16	7 7/8	7/8	8	3/4	3	3 7/8
5	11	1 1/8	9 1/4	7/8	8	3/4	3 1/4	4
6	12 1/2	1 3/16	10 5/8	7/8	12	3/4	3 1/4	4 1/8
8	15	1 3/8	13	1	12	7/8	3 3/4	4 3/4
10	17 1/2	1 7/16	15 1/4	1 1/8	16	1	4 1/4	5 1/4
12	20 1/2	1 7/32	17 3/4	1 1/4	16	1 1/8	4 1/2	5 3/4

When flanges are integral with valves or fittings, the bolt holes, which are in multiples of four, are drilled to straddle the center lines unless otherwise ordered. Full face gaskets extending to the flange edge as given in ANSI Standard Nonmetallic Gaskets to Pipe Flanges (ANSI B16.21) are required. Metallic gaskets should not be used.

Flanges are smooth finished over the entire face and are provided with two concentric gasket retaining grooves inside the bolt holes. When bronze flanges are bolted to cast iron or steel flanges which normally have a raised face, the raised face should be removed. See page E26.

Flange diameters and drilling templates of 150 lb bronze flanges are the same as corresponding sizes of the ANSI 125 lb Cast Iron Flange Standard, ANSI B16.1 and the ANSI Class 150 Steel Flange Standard, ANSI B16.5. The Class 300 bronze flange diameters and drilling templates are the same as corresponding sizes of the ANSI Class 250 Cast Iron Flange Standard, ANSI B16.1 and the ANSI Class 300 Steel Flange Standard, ANSI B16.5.