



SeaCor[®]

by GF Piping Systems

A Whole New Age In Marine Piping Systems.



USCG and ABS Approved

SeaCor is the first commercially available United States Coast Guard-approved marine plastic piping system in the world. It is the plastic potable water piping system that meets the IMO and USCG requirements for flame spread, low smoke and toxicity. It also carries Type Approval from the American Bureau of Shipping (ABS).



U. S. Department of Homeland Security
United States Coast Guard
Certificate of Approval

Coast Guard Approval Number: 164.141/36/0

Expires: 12 November 2024

PLASTIC PIPING SYSTEMS

Georg Fischer, LLC
 9271 Jeronimo Road
 Irvine CA 92618

SeaCor Pipes and Fittings.

SeaCor schedule 80 pipe of nominal diameters 1/2" to 12" meet Low Flame Spread, and Smoke and Toxicity requirements of the FTP Code Annex 1, Parts 2 and 5. May be installed in concealed spaces in accommodation, service, and control spaces, and need not meet the additional requirements of 46 CFR 56.60-25(a)(2).

SeaCor piping has not been subjected to fire endurance testing and is therefore not suitable for applications requiring fire endurance testing as specified in IMO Resolution A.753(18).

Identifying Data: Test Reports: SWRI Project Nos. 01.16052.01.647a and 01.16052.01.647b dated 16 November 2011. Follow-up Procedure Document No. 01.025000.02.198, Revision No. 1 dated January 2012.

Valid only for products manufactured at:
 Georg Fischer Harvel, LLC
 7777 Sloane Drive
 Little Rock, AR 72206

Product must be installed in accordance with manufacturer ASME B31.3 bonder qualifications certificates.

Extends certificate dated November 12, 2014.

*** End ***

THIS IS TO CERTIFY THAT the above named manufacturer has submitted to the undersigned with the applicable laws and regulations as outlined on the reverse side of this Certificate, and approval expires on the expiration date hereon unless sooner canceled or suspended by proper authority.

GIVEN UNDER MY HAND THIS
 NOVEMBER 2019, AT WASHINGTON



B. A. BALDWIN
 Chief, Lifesaving and Fire Safety Division
 BY DIRECTION OF THE COMMANDANT

DEPT. OF HOMELAND SECURITY, USCG, CGHQ-10030 (REV. 3-03)



Confirmation of Product Type Approval

Company Name: GEORG FISCHER HARVEL
Address: 7777 SLOANE DRIVE, LITTLE ROCK, AR, United States, 72206
Product: Thermoplastic Pipe, Fittings and Joints
Model(s): SeaCor
Endorsements:

Certificate Type	Certificate Number	Issue Date	Expiry Date
Product Design Assessment (PDA)	21-2079720-PDA	15-JAN-2021	14-JAN-2026
Manufacturing Assessment (MA)	17-NO3322526	27-APR-2017	18-MAY-2022
Product Quality Assurance (PQA)	NA	NA	NA

Tier
 3 - Type Approved, unit certification not required

Intended Service
 Marine & Offshore Application - Non-essential systems including fresh water, seawater, potable water, gray water, black water, vacuum flush sanitary piping, vents, drains, and brine services where no fire endurance testing or electrical conductivity is required.

Description
 SeaCor CPVC Schedule 80 pipe and fittings diameters 1/2" to 12"

Ratings
 Temperature range 32°F (0°C) to 210°F (99°C)

Max pressure rating for Schedule 80 CPVC Pipe at 73°F (23°C):

- 1/2" - 680 psi (46.9 bar);
- 3/4" - 550 psi (37.9 bar);
- 1" - 505 psi (34.8 bar);
- 1 1/4" - 415 psi (28.6 bar);
- 1 1/2" - 378 psi (26.0 bar);
- 2" - 323 psi (22.3 bar);
- 2 1/2" - 340 psi (23.4 bar);
- 3" - 300 psi (20.6 bar);

03/25/2021 8:28:34 AM

Copyright 2019 American Bureau of Shipping. All rights reserved.

Page 1 of 4

W&O: Your Source For the only United States Coast Guard Approved Marine Plastic Piping System – SeaCor®

W&O is the proud North American distributor for the groundbreaking SeaCor® piping systems from Georg Fischer – the first commercially available United States Coast Guard-Approved (USCG) marine plastic piping system in the world and is NSF Approved for potable water piping systems.

SeaCor® piping systems represent a unique, cost-saving solution to optimize vessel performance. Light in weight and long-lasting, the SeaCor® thermoplastic piping system can lower costs for ship owners and operators, both initially and over time. Costs for a SeaCor® piping system are competitive to copper piping systems, yet thermoplastic systems have a longer life span, sometimes as much as 25 years, making it a sound life-cycle investment.

SeaCor® provides a wide range of benefits to ship owners and operators and can be used in non-essential shipboard piping systems in locations including Category A machinery spaces, accommodation spaces, control spaces, cofferdams, void spaces and pipe tunnels.

SeaCor® is available in ½" through 12" Schedule 80 nominal pipe size. The product range also includes tees, elbows, couplings, adapters, and flanges, among others. SeaCor® can operate in temperatures ranging from 32°F (0°C) to 210°F (99°C) and under a working pressure of 279 PSI (19 Bar) at 73°F. USCG approvals require all individuals installing SeaCor® to be trained and qualified. W&O offers this training to its customers on-site or at a W&O facility. They have also committed to stocking SeaCor® in key locations in order to support the immediate needs of its marine and marine offshore clients.

About W&O

For four decades, W&O has focused exclusively on serving the maritime industry with products and services that go far beyond the expected. In the maritime industry, we have built a well-earned reputation for going the extra mile to make sure every need of every client is met, forming win-win strategic partnerships with those we serve.

W&O is among the world's largest suppliers of pipe, valves, fittings, actuation and engineered solutions to the marine and offshore industries. We also lead the way in ballast water treatment systems, energy conversation and fuel-management systems.

The industries we serve work 24/7, and so does W&O. Around the clock, every day of the year, we provide mission-critical products and services for our many strategically located service centers covering North America, Europe and Asia.



SeaCor by GF Piping Systems

+GF+

Table of Contents

	Page
SeaCor® Schedule 80 Pressure Pipes	5
SeaCor® Schedule 80 Pressure Fittings	6
SeaCor® Schedule 80 Reducer Fittings	9
SeaCor® Schedule 80 Caps & Plugs	13
SeaCor® Class 150# Flanges	14
SeaCor® Threaded Adaptor Fittings	16
SeaCor® Expansion Joints	19
SeaCor® Schedule 80 DWV Fittings	20
SeaCor® Valves	22
SeaCor® Pipe Supports & Gaskets	23
SeaCor® Installation Accessories	24
SeaCor® System Applications Matrix	25



SeaCor® Schedule 80 Pressure Pipes

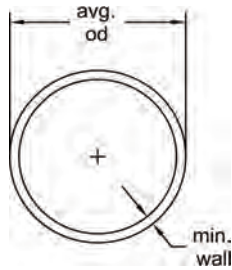

SeaCor® Pipe - Plain End - 20 ft lengths

Pipe Size (inch)	Plain End Part No.	Box Qty (ft)	Average O.D. (inch)	Min. Wall (inch)	Wt/Ft (lbs/ft)	Max Pressure @ 73°F (22.7°C) (psi)
1/2	814000.100	1400	0.84	0.15	0.23	850
3/4	814000.150	1200	1.05	0.15	0.31	690
1	814000.200	800	1.32	0.18	0.45	630
1-1/4	814000.250	500	1.66	0.19	0.62	520
1-1/2	814000.300	400	1.90	0.20	0.75	470
2	814000.400	240	2.38	0.22	1.04	400
2-1/2	814000.450	180	2.88	0.28	1.58	420
3	814000.500	120	3.50	0.30	2.12	370
4	814000.600	80	4.50	0.34	3.11	320
6	814000.700	40	6.63	0.43	5.93	280
8	814100.750	20	8.63	0.50	9.05	250
10	814100.800	20	10.75	0.59	13.43	230
12	814100.820	20	12.75	0.69	18.46	230

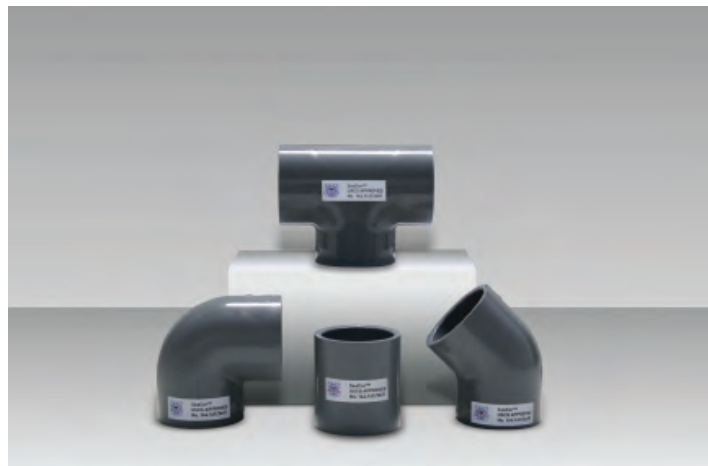



SeaCor® Elbow Fittings

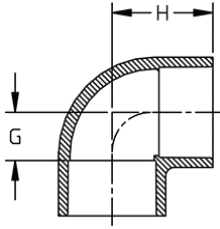

SeaCor® 90° EII (S x S)

Size (inch)	Part No.	Pack Qty	H (inch)	G (inch)	Weight (lbs.)
1/2	814101.100	25	1.41	0.50	0.09
3/4	814101.150	20	1.61	0.56	0.13
1	814101.200	15	1.86	0.69	0.24
1-1/4	814101.250	10	2.16	0.91	0.36
1-1/2	814101.300	10	2.41	1.03	0.49
2	814101.400	5	2.78	1.28	0.75
2-1/2	814101.450	5	3.29	1.53	1.30
3	814101.500	5	3.75	1.85	1.73
4	814101.600	5	4.59	2.34	3.05
6	814101.700	2	6.70	3.69	9.49
8	814101.750	1	8.52	4.47	15.30
10	814101.800	1	10.75	5.75	29.31
12	814101.820	1	12.63	6.06	44.00

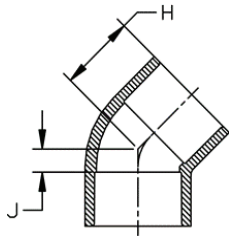

SeaCor® 45° EII (S x S)

Size (inch)	Part No.	Pack Qty	H (inch)	J (inch)	Weight (lbs.)
1/2	814104.100	25	1.21	0.25	0.08
3/4	814104.150	20	1.32	0.33	0.12
1	814104.200	15	1.47	0.29	0.18
1-1/4	814104.250	10	1.68	0.38	0.27
1-1/2	814104.300	10	1.88	0.44	0.37
2	814104.400	5	2.16	0.60	0.59
2-1/2	814104.450	5	2.53	0.76	0.90
3	814104.500	5	2.66	0.78	1.41
4	814104.600	5	3.24	0.95	2.37
6	814104.700	2	4.81	1.74	7.18
8	814104.750	2	6.11	2.02	12.59
10	814104.800	1	7.50	2.50	23.56
12	814104.820	1	9.00	3.00	38.87

SeaCor® Pressure Fittings

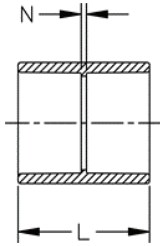

SeaCor® Coupling (S x S)

Size (inch)	Part No.	Pack Qty	L (inch)	N (inch)	Weight (lbs.)
1/2	814150.100	25	1.93	0.13	0.09
3/4	814150.150	20	2.18	0.13	0.13
1	814150.200	15	2.41	0.13	0.20
1-1/4	814150.250	10	2.64	0.12	0.29
1-1/2	814150.300	10	2.90	0.13	0.40
2	814150.400	5	3.14	0.12	0.63
2-1/2	814150.450	5	3.75	0.16	0.94
3	814150.500	5	4.05	0.25	1.05
4	814150.600	5	4.79	0.25	1.71
6	814150.700	2	6.41	0.34	3.39
8	814150.750	2	8.40	0.34	7.91
10	814150.800	1	10.54	0.50	11.67
12	814150.820	1	12.54	0.50	20.85

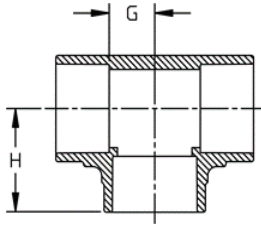

SeaCor® Tee (S x S x S)

Size (inch)	Part No.	Pack Qty	H (inch)	G (inch)	Weight (lbs.)
1/2	814121.100	25	1.49	0.50	0.16
3/4	814121.150	20	1.61	0.56	0.15
1	814121.200	15	1.86	0.72	0.33
1-1/4	814121.250	10	2.19	0.91	0.47
1-1/2	814121.300	10	2.44	1.06	0.68
2	814121.400	5	2.82	1.32	0.97
2-1/2	814121.450	5	3.33	1.50	1.76
3	814121.500	5	3.75	1.85	2.56
4	814121.600	5	4.63	2.38	4.17
6	814121.700	2	6.53	3.53	12.02
8	814121.750	1	8.63	4.59	21.49
10	814121.800	1	11.25	5.75	40.10
12	814121.820	1	13.35	6.89	55.50



SeaCor® Union Fittings

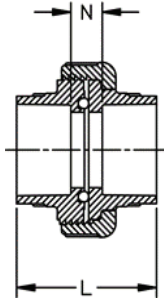

SeaCor® Union Type 375 (S x S)

Size (inch)	Part No. EPDM	Part No. FKM	Pack Qty	L (inch)	N (inch)	Weight (lbs.)
1/2	814301E.100	814301F.100	25	2.58	0.80	0.07
3/4	814301E.150	814301F.150	10	2.82	0.82	0.11
1	814301E.200	814301F.200	5	3.14	0.88	0.17
1-1/4	814301E.250	814301F.250	5	3.49	0.99	0.25
1-1/2	814301E.300	814301F.300	5	3.70	0.95	0.39
2	814301E.400	814301F.400	2	4.11	1.11	0.65
3	814301E.500	814301F.500	2	4.75	0.99	3.19
4	814301E.600	814301F.600	2	5.72	1.14	4.72

• 235 psi @ 73°F (16.2 bar @ 22.7°C)

SeaCor® Metal Union End FPT Connectors Type 375 (316 SS)



Size (inch)	Part No.	Pack Qty	Weight (lbs.)
1/2	814298.100	1	0.34
3/4	814298.150	1	0.43
1	814298.200	1	0.70
1-1/4	814298.250	1	1.07
1-1/2	814298.300	1	1.27
2	814298.400	1	1.85

SeaCor® Reducer Fittings

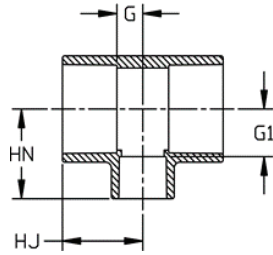

SeaCor® Reducing Tee (S x S x S)

Size (inch)	Part No.	Pack Qty	HJ (inch)	HN (inch)	G (inch)	G1 (inch)	Weight (lbs.)
3/4 x 1/2	814121R.149	20	1.63	1.63	0.61	0.73	0.25
1 x 1/2	814121R.198	15	1.88	1.63	0.73	0.75	0.33
1 x 3/4	814121R.199	15	1.88	1.87	0.73	0.86	0.35
1-1/4 x 1	814121R.249	10	2.00	2.00	0.73	0.91	0.47
1-1/2 x 1/2	814121R.296	10	2.41	2.70	1.03	1.82	0.49
1-1/2 x 3/4	814121R.297	10	2.00	2.00	0.61	1.05	1.12
1-1/2 x 1	814121R.298	10	2.13	2.20	0.73	0.81	0.83
2 x 1/2	814121R.395	5	2.78	3.06	1.28	1.22	0.49
2 x 3/4	814121R.396	5	2.13	2.31	0.73	1.29	1.22
2 x 1	814121R.397	5	2.25	2.44	0.73	1.26	0.97
2 x 1-1/2	814121R.399	5	2.56	2.69	1.05	1.29	1.07
2-1/2 x 2	814121R.449	5	3.04	3.04	1.28	1.53	1.30
3 x 1-1/4	814121R.496	5	3.21	4.09	1.31	2.43	1.95
3 x 1-1/2	814121R.497	5	3.21	4.07	1.31	2.27	3.30
3 x 2	814121R.498	5	3.21	3.40	1.31	1.87	1.73
3 x 2-1/2	814121R.499	5	3.75	4.08	1.85	2.24	1.96
4 x 2	814121R.596	5	3.52	3.88	1.26	2.37	5.45
4 x 3	814121R.598	5	4.15	4.31	1.87	2.39	3.53
6 x 2	814121R.694	2	6.58	7.21	3.56	5.65	12.74
6 x 3	814121R.696	2	6.58	7.21	3.56	5.26	12.67
6 x 4	814121R.698	2	6.58	6.81	3.49	4.50	10.53
8 x 4	814121R.747	1	7.63	8.09	3.59	5.84	25.22
8 x 6	814121R.749	1	7.63	7.52	3.59	4.50	21.61
10 x 6	814121R.817	1	11.25	11.88	5.75	8.32	45.53
10 x 8	814121R.799	1	11.25	11.88	5.75	7.32	49.79
12 x 8	814121R.818	1	13.35	14.00	6.89	9.52	66.31
12 x 10	814121R.819	1	13.35	14.00	6.89	8.52	67.14



SeaCor® Reducer Fittings

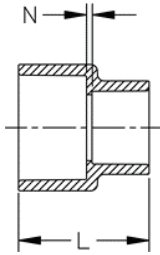

SeaCor® Reducing Coupling (S x S)

Size (inch)	Part No.	Pack Qty	L (inch)	N (inch)	Weight (lbs.)
3/4 x 1/2	814150R.149	20	2.16	0.14	0.10
1 x 1/2	814150R.198	15	2.12	0.09	0.14
1 x 3/4	814150R.199	15	2.26	0.12	0.15
1-1/2 x 1/2	814150R.296	10	2.93	0.64	0.23
1-1/2 x 3/4	814150R.297	10	2.93	0.54	0.94
1-1/2 x 1	814150R.298	10	2.66	0.10	0.94
1-1/2 x 1-1/4	814150R.299	10	2.82	0.10	0.29
2 x 1/2	814150R.395	5	3.39	0.87	0.30
2 x 3/4	814150R.396	5	3.39	0.77	0.61
2 x 1	814150R.397	5	3.12	0.33	0.62
2 x 1-1/4	814150R.398	5	3.37	0.52	0.71
2 x 1-1/2	814150R.399	5	3.05	0.10	0.45
2-1/2 x 1-1/2	814150R.448	5	3.30	0.13	0.50
2-1/2 x 2	814150R.449	5	4.00	0.65	1.20
3 x 1-1/2	814150R.497	5	3.91	0.56	0.93
3 x 2	814150R.498	5	3.61	0.16	1.00
3 x 2-1/2	814150R.499	5	4.58	0.64	1.56
4 x 2	814150R.596	5	4.94	1.12	2.61
4 x 2-1/2	814150R.597	5	4.92	0.65	2.33
4 x 3	814150R.598	5	4.39	0.26	1.82
6 x 2-1/2	814150R.696	2	10.25	3.50	8.74
6 x 3	814150R.697	2	10.25	3.50	8.23
6 x 4	814150R.698	2	10.25	3.50	7.30
8 x 4	814150R.747	1	8.75	2.59	12.15
8 x 6	814150R.749	2	9.12	2.07	8.23
10 x 6	814150R.798	1	11.17	3.07	21.69
10 x 8	814150R.799	1	11.17	2.07	17.10
12 x 8	814150R.818	1	13.17	3.13	31.66
12 x 10	814150R.819	1	13.17	2.13	32.49

SeaCor® Reducer Fittings

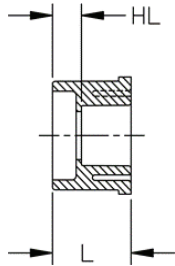

SeaCor® Flush Style Reducer Bushing (SPG x S)

Size (inch)	Part No.	Pack Qty	HL (inch)	L (inch)	Weight (lbs.)
3/4 x 1/2	814157.149	20	0.40	1.29	0.03
1 x 1/2	814157.198	15	0.54	1.42	0.07
1 x 3/4	814157.199	15	0.44	1.42	0.05
1-1/4 x 1/2	814157.247	10	0.66	1.56	0.11
1-1/4 x 3/4	814157.248	10	0.55	1.57	0.11
1-1/4 x 1	814157.249	10	0.42	1.57	0.08
1-1/2 x 1/2	814157.296	10	0.77	1.68	0.16
1-1/2 x 3/4	814157.297	10	0.67	1.69	0.17
1-1/2 x 1	814157.298	10	0.55	1.68	0.14
1-1/2 x 1-1/4	814157.299	10	0.42	1.70	0.09
2 x 1/2	814157.395	5	0.88	1.79	0.23
2 x 3/4	814157.396	5	0.78	1.81	0.24
2 x 1	814157.397	5	0.66	1.81	0.24
2 x 1-1/4	814157.398	5	0.56	1.82	0.22
2 x 1-1/2	814157.399	5	0.40	1.80	0.18
2-1/2 x 1-1/2	814157.448	5	0.96	2.43	0.39
2-1/2 x 2	814157.449	5	0.55	2.13	0.26
3 x 1	814157.495	5	1.53	2.68	0.47
3 x 1-1/2	814157.497	5	0.92	2.43	0.74
3 x 2	814157.498	5	0.87	2.43	0.79
3 x 2-1/2	814157.499	5	0.39	2.23	0.51
4 x 2	814157.596	5	1.15	2.72	1.26
4 x 3	814157.598	5	0.77	2.76	0.93
6 x 2	814157.695	2	1.13	4.03	5.18
6 x 3	814157.696	2	1.79	3.66	3.48
6 x 4	814157.698	2	1.13	3.66	3.92
8 x 2	814157.744	1	1.56	5.59	9.77
8 x 3	814157.745	1	1.56	5.15	8.07
8 x 4	814157.747	1	1.56	5.15	8.51
8 x 6	814157.749	1	1.56	4.66	4.59
10 x 6	814157.798	1	2.57	5.66	10.02
10 x 8	814157.799	1	1.57	5.66	5.43
12 x 8	814157.818	1	2.63	6.72	10.81
12 x 10	814157.819	1	1.63	6.72	11.64



SeaCor® Reducer Fittings

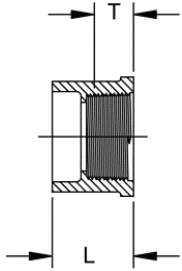

SeaCor® Flush Style Reducer Bushing (SPG x FPT)

Size (inch)	Part No.	Pack Qty	HL (inch)	L (inch)	Weight (lbs.)
1/2 x 1/4	814157.098.FPT	10	1.20	0.53	0.02
3/4 x 1/2	814157.149.FPT	20	1.28	0.53	0.03
1 x 1/2	814157.198.FPT	15	1.42	0.53	0.07
1 x 3/4	814157.199.FPT	15	1.41	0.55	0.06
1-1/4 x 1/2	814157.247.FPT	10	1.53	0.53	0.12
1-1/4 x 3/4	814157.248.FPT	10	1.56	0.55	0.11
1-1/4 x 1	814157.249.FPT	10	1.55	0.68	0.09
1-1/2 x 1/2	814157.296.FPT	10	1.68	0.53	0.16
1-1/2 x 3/4	814157.297.FPT	10	1.68	0.55	0.16
1-1/2 x 1	814157.298.FPT	10	1.69	0.68	0.15
1-1/2 x 1-1/4	814157.299.FPT	10	1.68	0.71	0.10
2 x 1/2	814157.395.FPT	5	1.80	0.53	0.23
2 x 3/4	814157.396.FPT	5	1.80	0.55	0.24
2 x 1	814157.397.FPT	5	1.79	0.68	0.24
2 x 1-1/4	814157.398.FPT	5	1.78	0.71	0.22
2 x 1-1/2	814157.399.FPT	5	1.79	0.72	0.19
2-1/2 x 1-1/2	814157.448.FPT	5	2.11	0.72	0.45
2-1/2 x 2	814157.449.FPT	5	2.20	0.76	0.39
3 x 2	814157.498.FPT	5	2.44	0.76	0.83
4 x 2	814157.596.FPT	5	2.73	0.76	1.36
4 x 3	814157.598.FPT	5	2.75	0.38	1.36

SeaCor® Caps and Plugs

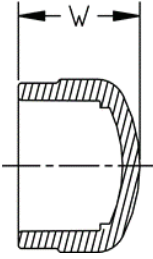

SeaCor® Cap (S)

Size (inch)	Part No.	Pack Qty	W (inch)	Weight (lbs.)
1/2	814154.100	25	1.29	0.06
3/4	814154.150	20	1.46	0.08
1	814154.200	15	1.67	0.13
1-1/4	814154.250	10	1.88	0.17
1-1/2	814154.300	10	2.09	0.31
2	814154.400	5	2.32	0.32
2-1/2	814154.450	5	2.73	0.78
3	814154.500	5	3.05	1.01
4	814154.600	5	3.67	1.55
6	814154.700	2	4.93	3.73
8	814154.750	2	6.29	8.23
10	814154.800	1	7.88	13.30
12	814154.820	1	9.38	19.81

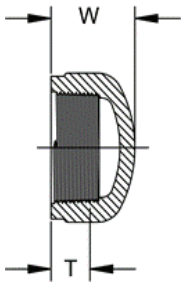

SeaCor® Cap (FPT)

Size (inch)	Part No.	Pack Qty	W (inch)	T (inch)	Weight (lbs.)
1/2	814155.100	25	1.16	0.53	0.06
3/4	814155.150	20	1.24	0.55	0.07
1	814155.200	15	1.50	0.68	0.13
1-1/4	814155.250	10	1.61	0.71	0.21
1-1/2	814155.300	10	1.66	0.72	0.22
2	814155.400	5	1.84	0.76	0.40

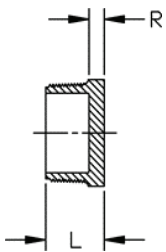

SeaCor® Plug (MPT)

Size (inch)	Part No.	Pack Qty	L (inch)	R (inch)	Weight (lbs.)
1/2	814065.100	10	0.97	0.22	0.02
3/4	814065.150	20	1.04	0.25	0.03
1	814065.200	10	1.25	0.27	0.05
1-1/2	814065.300	10	1.38	0.34	0.11
2	814065.400	5	1.46	0.40	0.16
3	814065.500	5	2.00	0.38	0.46
4	814065.600	5	2.15	0.38	0.79
6	814065.700	2	2.00	0.75	0.84



SeaCor® Flanges

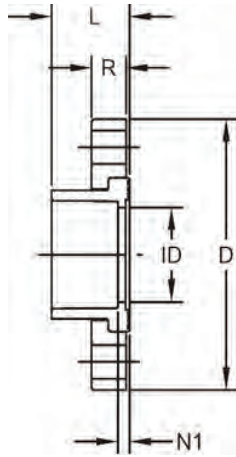

SeaCor® Flange - Van Stone (S)

Size (inch)	Part No.	Pack Qty	# holes	Bolt Dia.	Bolt Cir.	D (inch)	L (inch)	N1 (inch)	R (inch)	ID (inch)	Weight (lbs.)
1/2	814100.1.100	5	4	1/2	2.38	3.50	1.03	0.11	0.57	0.63	0.22
3/4	814100.1.150	5	4	1/2	2.75	3.88	1.15	0.13	0.58	0.84	0.28
1	814100.1.200	5	4	1/2	3.13	4.25	1.38	0.11	0.66	1.06	0.38
1-1/4	814100.1.250	5	4	1/2	3.50	4.63	1.45	0.14	0.69	1.40	0.46
1-1/2	814100.1.300	5	4	1/2	3.88	5.00	1.59	0.15	0.76	1.61	0.59
2	814100.1.400	5	4	5/8	4.75	6.00	1.76	0.20	0.82	2.10	1.04
2-1/2	814100.1.450	5	4	5/8	5.50	7.00	2.05	0.22	0.98	2.50	1.91
3	814100.1.500	5	4	5/8	6.00	7.50	2.25	0.30	1.02	3.11	2.23
4	814100.1.600	5	8	5/8	7.50	9.00	2.65	0.34	1.11	4.07	3.11
6	814100.1.700	2	8	3/4	9.50	11.00	3.59	0.48	1.27	6.13	5.02
8	814100.750	2	8	3/4	11.75	13.50	4.63	0.50	1.73	8.02	8.92
10	814100.800	2	12	7/8	14.25	16.00	5.63	0.50	1.73	10.09	14.50
12	814100.820	2	12	7/8	17.00	19.00	6.69	0.56	1.73	11.98	21.31

• 150 psi @ 73°F (10.3 bar @ 22.7°C)

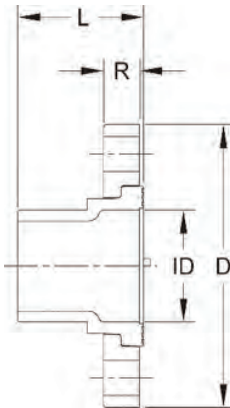

SeaCor® Flange - Van Stone (SPG)

Size (inch)	Part No.	Pack Qty	# holes	Bolt Dia.	Bolt Cir.	D (inch)	L (inch)	R (inch)	ID (inch)	Weight (lbs.)
1/2	814073.100	5	4	1/2	2.38	3.50	1.65	0.57	0.84	0.23
3/4	814073.150	5	4	1/2	2.75	3.88	1.78	0.58	1.05	0.30
1	814073.200	5	4	1/2	3.13	4.25	2.02	0.66	1.32	0.40
1-1/4	814073.250	5	4	1/2	3.50	4.63	2.20	0.69	1.66	0.50
1-1/2	814073.300	5	4	1/2	3.88	5.00	2.40	0.76	1.90	0.64
2	814073.400	5	4	5/8	4.75	6.00	2.72	0.82	2.37	1.13
2-1/2	814073.450	5	4	5/8	5.50	7.00	3.19	0.98	2.87	1.91
3	814073.500	5	4	5/8	6.00	7.50	3.52	1.02	3.50	2.32
4	814073.600	5	8	5/8	7.50	9.00	4.02	1.11	4.50	3.23
6	814073.700	2	8	3/4	9.50	11.00	5.09	1.37	6.62	5.29
8	814073.750	2	8	3/4	11.75	13.50	6.85	1.73	8.63	10.73
10	814073.800	2	12	7/8	14.25	16.00	8.33	1.73	10.75	13.02
12	814073.820	2	12	7/8	17.00	19.00	9.54	1.73	12.72	24.81

• 150 psi @ 73°F (10.3 bar @ 22.7°C)

SeaCor® Flange Dimensions are in accordance with ASME B16.5.
PN10 DIN and 10K JIS flanges are available.

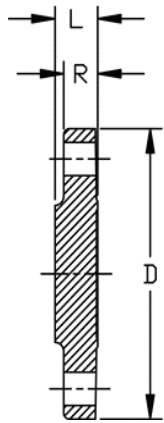

SeaCor® Flanges

SeaCor® Flange (Blind)

Size (inch)	Part No.	Pack Qty	# holes	Bolt Dia.	Bolt Cir.	D (inch)	L (inch)	R (inch)	Weight (lbs.)
1/2	814172.100	5	4	1/2	2.38	3.50	0.50	0.43	0.28
3/4	814172.150	5	4	1/2	2.75	3.88	0.50	0.44	0.37
1	814172.200	5	4	1/2	3.13	4.25	0.60	0.57	0.45
1-1/4	814172.250	5	4	1/2	3.50	4.63	0.63	0.56	0.64
1-1/2	814172.300	5	4	1/2	3.88	5.00	0.82	0.71	0.84
2	814172.400	5	4	5/8	4.75	6.00	0.92	0.74	1.14
2-1/2	814172.450	5	4	5/8	5.50	7.00	0.96	0.78	1.12
3	814172.500	5	4	5/8	6.00	7.50	1.03	0.89	2.85
4	814172.600	5	8	5/8	7.50	9.00	1.35	1.12	4.73
6	814172.700	2	8	3/4	9.50	11.00	1.49	1.27	7.58
8	814172.750	2	8	3/4	11.75	13.50	1.63	1.45	9.23
10	814172.800	1	12	7/8	14.25	16.00	1.00	1.00	10.78
12	814172.820	1	12	7/8	17.00	19.00	1.00	1.00	15.09

• 150 psi @ 73°F (10.3 bar @ 22.7°C)



SeaCor® Adapter Fittings

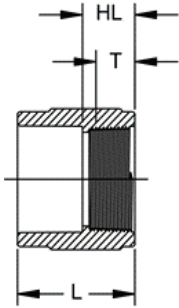

SeaCor® Female Adapter (S x FPT)

Size (inch)	Part No.	Pack Qty	HL (inch)	L (inch)	T (inch)	Weight (lbs.)
1/2	814151.100	25	0.91	1.79	0.53	0.09
3/4	814151.150	20	0.95	1.96	0.55	0.11
1	814151.200	15	1.11	2.26	0.68	0.19
1-1/4	814151.250	10	1.16	2.44	0.71	0.27
1-1/2	814151.300	10	1.19	2.58	0.72	0.34
2	814151.400	5	1.23	2.74	0.76	0.48
3	814151.500	5	1.91	3.82	1.20	1.12
4	814151.600	5	2.02	4.29	1.30	1.73

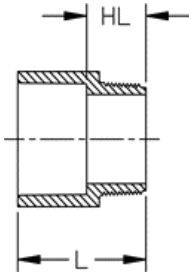

SeaCor® Male Adapter (S x MPT)

Size (inch)	Part No.	Pack Qty	HL (inch)	L (inch)	Weight (lbs.)
1/2	814160.100	25	0.98	1.86	0.05
3/4	814160.150	20	1.00	2.04	0.06
1	814160.200	15	1.21	2.39	0.10
1-1/4	814160.250	10	1.29	2.56	0.16
1-1/2	814160.300	10	1.32	2.72	0.19
2	814160.400	5	1.35	2.88	0.28
3	814160.500	5	2.02	3.92	0.73
4	814160.600	5	2.08	4.40	1.21

SeaCor® Adapter Fittings

SeaCor® Female Adapter (S x FPT) CPVC to 316SS

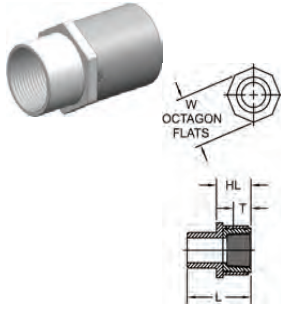

Size (inch)	Part No.	Pack Qty	HL (inch)	L (inch)	T (inch)	W (inch)	Weight (lbs.)
1/2	814151.100	10	1.49	2.38	0.84	1.25	0.20
3/4	814151.150	10	1.67	2.68	0.92	1.50	0.33
1	814151.200	6	1.98	3.11	0.96	1.75	0.50
1-1/4	814151.250	5	2.19	3.45	1.04	2.12	0.75
1-1/2	814151.300	5	2.35	3.73	1.04	2.50	0.98
2	814151.400	4	2.63	4.14	1.29	3.00	1.47

• 400 psi @ 73°F (27.6 bar @ 22.7°C)

SeaCor® Male Adapter (S x MPT) CPVC to 316SS

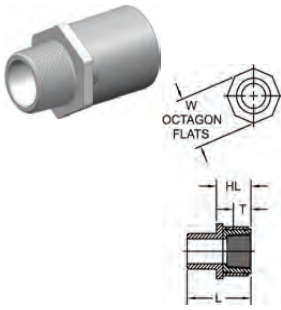

Size (inch)	Part No.	Pack Qty	HL (inch)	L (inch)	T (inch)	W (inch)	Weight (lbs.)
1/2	814161.100	10	1.49	2.38	0.70	1.25	0.20
3/4	814161.150	10	1.67	2.68	0.74	1.50	0.33
1	814161.200	6	1.98	3.11	0.92	1.75	0.50
1-1/4	814161.250	5	2.19	3.45	0.95	2.12	0.75
1-1/2	814161.300	5	2.35	3.73	0.99	2.50	0.98
2	814161.400	4	2.64	4.14	1.03	3.00	1.47

• 400 psi @ 73°F (27.6 bar @ 22.7°C)



SeaCor® Transition Fittings

SeaCor® Transition Fittings (SPG x FPT) CPVC to 316SS



Size (inch)	Part No.	Pack Qty	HL (inch)	L (inch)	T (inch)	W (inch)	Weight (lbs.)
1/2	814063.100	25	1.02	1.76	0.53	1.25	0.12
3/4	814063.150	20	1.09	2.08	0.55	1.50	0.21
1	814063.200	15	1.33	2.45	0.68	1.88	0.37
1-1/4	814063.250	10	1.39	2.51	0.71	2.25	0.54
1-1/2	814063.300	10	1.45	2.76	0.72	2.56	0.66
2	814063.400	5	1.44	2.82	0.76	3.31	1.04

• 150 psi @ 73°F (10.3 bar @ 22.7°C)

SeaCor® Drop Ear (S x MPT) CPVC to 316SS

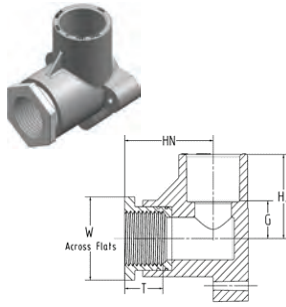

Size (inch)	Part No.	Pack Qty	G (inch)	HJ (inch)	HN (inch)	T (inch)	Weight (lbs.)
1/2	814102.100	5	0.62	1.50	1.52	0.90	1.13
3/4	814102.150	5	0.76	1.77	1.65	0.95	1.31
1	814102.200	5	0.87	2.00	2.20	1.00	1.75

• 400 psi @ 73°F (27.6 bar @ 22.7°C)

SeaCor® Expansion Joints

SeaCor® Expansion Joint 6" Travel (S x S)

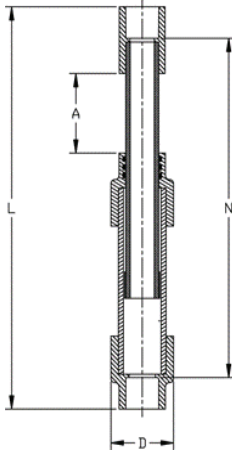

Size (inch)	Part No.	Pack Qty	A (inch)	D (inch)	L (inch)	N (inch)	Weight (lbs.)
1/2	814EXP6.100	1	3.00	1.85	13.93	12.06	0.86
3/4	814EXP6.150	1	3.00	2.23	14.40	12.46	1.18
1	814EXP6.200	1	3.00	2.50	15.02	12.58	1.76
1-1/4	814EXP6.250	1	3.00	2.50	15.81	13.05	1.97
1-1/2	814EXP6.300	1	3.00	3.50	16.08	13.13	3.15
2	814EXP6.400	1	3.00	4.39	18.10	14.88	5.37
3	814EXP6.500	1	3.00	5.53	19.83	15.79	10.09
4	814EXP6.600	1	3.00	7.93	27.56	23.01	29.19
6	814EXP6.700	1	3.00	9.97	27.88	21.75	44.83
8	814EXP6.750	1	3.00	10.75	25.34	17.30	43.92
10	814EXP6.800	1	3.00	12.75	29.64	19.60	79.14

- 1-1/2" - 2" 235 psi @ 73°F (16.2 bar @ 22.7°C)
- 3" - 6" 150 psi @ 73°F (10.3 bar @ 22.7°C)

SeaCor® Expansion Joint 12" Travel (S x S)

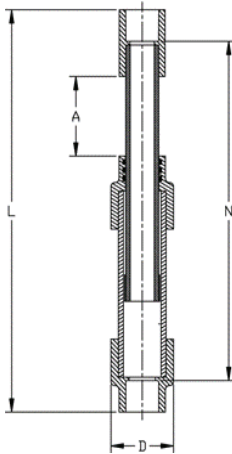

Size (inch)	Part No.	Pack Qty	A (inch)	D (inch)	L (inch)	N (inch)	Weight (lbs.)
1/2	814EXP12.100	1	6.00	1.85	22.93	21.06	1.38
3/4	814EXP12.150	1	6.00	2.23	23.40	21.46	1.69
1	814EXP12.200	1	6.00	2.50	24.02	21.58	2.39
1-1/4	814EXP12.250	1	6.00	2.50	24.81	22.05	2.68
1-1/2	814EXP12.300	1	6.00	3.50	25.08	22.13	4.07
2	814EXP12.400	1	6.00	4.39	27.10	23.88	6.98
3	814EXP12.500	1	6.00	5.53	28.83	24.79	13.14
4	814EXP12.600	1	6.00	7.93	36.56	32.01	38.26
6	814EXP12.700	1	6.00	9.97	36.88	30.75	60.25

- 1-1/2" - 2" 235 psi @ 73°F (16.2 bar @ 22.7°C)
- 3" - 6" 150 psi @ 73°F (10.3 bar @ 22.7°C)



SeaCor® DWV Fittings

SeaCor® 1/4" Bend Short Sweep (S x S)

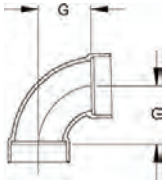

Size (inch)	Part No.	Pack Qty	G (inch)	Weight (lbs.)
1-1/2	814111.300	4	1.75	0.35
2	814111.400	4	2.31	0.60
3	814111.500	1	3.06	1.69
4	814111.600	1	3.88	2.90

SeaCor® 1/4" Bend Long Sweep (S x S) - FAB

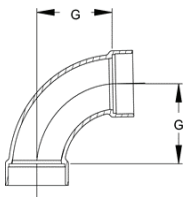

Size (inch)	Part No.	Pack Qty	G (inch)	Weight (lbs.)
1-1/2	814111.300.LS	4	1.75	0.35
2	814111.400.LS	4	2.31	0.60
3	814111.500.LS	1	3.06	1.69
4	814111.600.LS	1	3.88	2.90

SeaCor® Sanitary Tee (S x S x S)

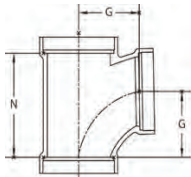

Size (inch)	Part No.	Pack Qty	G (inch)	N (inch)	Weight (lbs.)
1-1/2	814130.300	5	1.75	2.75	0.46
2	814130.400	5	2.31	3.69	0.81
3	814130.500	5	3.06	4.88	2.23
4	814130.600	5	3.88	6.13	3.90

SeaCor® 45° Wye (S x S x S)

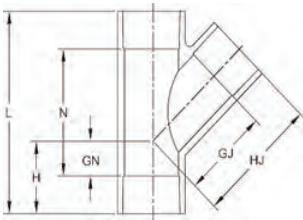

Size (inch)	Part No.	Pack Qty	GJ (inch)	GN (inch)	H (inch)	HJ (inch)	L (inch)	N (inch)	Weight (lbs.)
1-1/2	814140.300	4	2.88	1.12	2.51	4.26	6.77	4.00	0.83
2	814140.400	4	3.61	1.38	2.89	5.16	8.05	5.00	1.37
3	814140.500	4	5.00	1.66	3.55	6.88	10.46	6.63	3.54
4	814140.600	4	6.38	1.84	4.20	8.75	12.96	8.25	4.98
6	814140.700	2	8.50	1.81	4.86	11.59	16.50	10.39	13.55

- 1-1/2" - 2" 235 psi @ 73°F (16.2 bar @ 22.7°C)
- 3" - 6" 150 psi @ 73°F (10.3 bar @ 22.7°C)

SeaCor® DWV Fittings

SeaCor® 45° Wye (S x S x S)

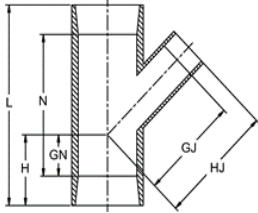

Size (inch)	Part No.	Pack Qty	GJ (inch)	GN (inch)	H (inch)	HJ (inch)	L (inch)	N (inch)
2 x 1-1/2	814140R.399	4	4.03	1.38	2.88	5.43	8.02	5.00
3 x 1-1/2	814140R.497	4	5.92	1.87	3.77	7.43	10.46	6.65
3 x 2	814140R.498	4	5.87	1.87	3.77	7.43	10.46	6.65
4 x 2	814140R.596	4	7.53	1.88	4.20	9.10	12.91	8.25
4 x 3	814140R.598	4	7.15	1.88	4.20	9.14	12.91	8.25
6 x 3	814140R.696	2	9.95	1.87	4.91	12.09	16.50	10.39
6 x 4	814140R.698	2	7.18	1.87	4.91	9.45	16.50	10.39

- 2" 235 psi @ 73°F (16.2 bar @ 22.7°C)
- 3" - 6" 150 psi @ 73°F (10.3 bar @ 22.7°C)

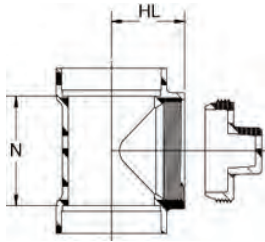

SeaCor® Cleanout Tee (S x S)

Size (inch)	Part No.	Pack Qty	HL (inch)	N (inch)	Weight (lbs.)
1-1/2	814122.300	2	2.07	1.80	0.46
2	814122.400	2	2.35	2.32	0.81
3	814122.500	2	3.51	3.63	2.23
4	814122.600	2	4.07	4.25	3.90



SeaCor® Valves

SeaCor® Cone Check Valve (S x S)

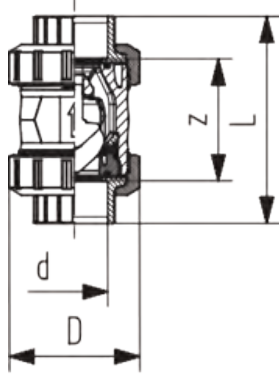

Size (inch)	Part No.	D (inch)	L (inch)	Z (inch)	Weight (lbs.)
1/2	814561.100	1.97	4.13	2.40	0.29
3/4	814561.150	2.28	4.76	2.76	0.62
1	814561.200	2.68	5.24	2.99	0.66
1-1/4	814561.250	3.31	6.06	3.54	1.12
1-1/2	814561.300	3.82	6.46	3.70	1.67
2	814561.400	4.88	7.20	4.21	2.93
2-1/2	814561.450	6.54	9.17	5.67	7.15
3	814561.500	7.87	10.00	5.94	11.22
4	814561.600	9.37	11.85	6.85	18.02

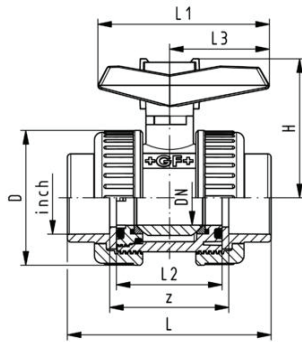

SeaCor® Ball Valve (S x S)

Size (inch)	Part No.	Z (inch)	L2 (inch)	L3 (inch)	D (inch)	L1 (inch)	L (inch)	H (inch)	Weight (lbs.)
1/2	814375.100	1.89	1.65	1.57	1.97	2.64	3.15	2.09	0.80
3/4	814375.150	2.09	1.89	1.77	2.32	3.03	3.58	2.36	1.00
1	814375.200	2.28	2.13	2.01	2.68	3.43	4.02	2.64	1.20
1-1/4	814375.250	2.68	2.44	2.32	3.15	4.02	4.72	3.11	1.50
1-1/2	814375.300	3.07	2.83	2.76	3.70	4.69	5.51	3.54	2.00
2	814375.400	3.66	3.39	3.31	4.53	5.75	6.65	4.21	4.00
2-1/2	814375.450	5.67	5.35	8.11	6.54	10.63	9.17	5.87	10.50
3	814375.500	5.94	5.55	8.11	7.87	10.63	10.00	6.34	11.00
4	814375.600	6.85	6.46	10.08	9.37	12.60	11.85	7.01	17.50

- 3-Piece Union End, Floating Ball Design
- Full Schedule 80 bore
- Blow-out proof stem with double o-rings
- PTFE Seats w/ backing o-rings
- 1/2" - 2" are supplied with both socket and threaded end connections

SeaCor® Pipe Supports & Gaskets

SeaCor® Rubber Lined Pipe Supports



NPS (inch)	Electroplate Steel	304 Stainless Steel	A (inch)	B (inch)	C (inch)
1/2	838.CLAMP.STL.20-25	838.CLAMP.SS.20-25	3.31	2.28	2.36
3/4	838.CLAMP.STL.25-30	838.CLAMP.SS.25-30	3.46	2.56	2.44
1	838.CLAMP.STL.32-37	838.CLAMP.SS.32-37	3.66	2.64	2.56
1-1/4	838.CLAMP.STL.40-45	838.CLAMP.SS.40-45	3.94	2.91	2.68
1-1/2	838.CLAMP.STL.48-53	838.CLAMP.SS.48-53	4.33	3.31	2.87
2-1/2	838.CLAMP.STL.54-58	838.CLAMP.SS.54-58	4.72	3.70	3.07
3	838.CLAMP.STL.89-91	838.CLAMP.SS.89-91	5.31	4.29	3.39
4	838.CLAMP.STL.108-112	838.CLAMP.SS.108-112	5.94	4.92	3.70

- EPDM Rubber Insulation for Sound Reduction & Isolation
- Available in Zinc Plated Steel or 304 Stainless Steel
- Temperature Rating: 58°F - 203°F
- 1/4" Threaded Boss

SeaCor® 150# Full Face Flange Gaskets, 6800 EPDM Garlock® Stress Saver®, Water Service



Size (inch)	Part No. Water Service
1/2	988.36680-0001
3/4	988.36680-0002
1	988.36680-0003
1-1/4	988.36680-0004
1-1/2	988.36680-0005
2	988.36680-0006
2-1/2	988.36680-0007
3	988.36680-0008
4	988.36680-7104
6	988.36680-7106
8	988.36680-7108

The Garlock® STRESS SAVER® family of products feature molded, raised ribs that help to create a tighter seal by concentrating the compressive load, ideal for lightweight piping and non-metallic flange applications where low bolt load and chemical resistance are needed.

For water applications including potable, the Full Face Seacor® Gasket is recommended. With service range of -40°F to 300°F and pressures up to 250 PSI, this molded EPDM gasket offer excellent sealing characteristics at an economical price.

SeaCor® 150# Full Face Flange Gaskets, 370 PTFE/EPDM Garlock® Stress Saver®, Chemical Service



Size (inch)	Part No. Chemical Service
1/2	988.36010-0001
3/4	988.36010-0002
1	988.36010-0003
1-1/2	988.36010-0005
2	988.36010-0006

The Garlock® STRESS SAVER® family of products feature molded, raised ribs that help to create a tighter seal by concentrating the compressive load, ideal for lightweight piping and non-metallic flange applications where low bolt load and chemical resistance are needed.

The Seacor® Chemical Gasket is designed for chemical applications, including injection. This gasket has a pure PTFE sealing surface with an EPDM body to provide leakfree service in corrosive chemical service.



W&O recommends the use of accessories specifically designed for use on plastic piping systems. These accessories will increase production efficiency and conform to the required installation process to minimize the possibility of an incorrect installation solvent weld connection.

SeaCor® Primer and Cement



SeaCor® Primer and Cement ARE REQUIRED to install the Seacor System; these are specially formulated and include special fluorescent properties that let the inspectors check that the proper joining products were used in the installation process.

SeaCor® Primer and Cement come standard in quart cans and include a can top dauber for 1-1/2"-3" pipe size*.

Part No.	Description
814CEMENT.QT	SeaCor® Cement Quart with Dauber Cap
814PRIMER.QT	SeaCor® Primer Quart with Dauber Cap

Applicators

The use of the correct size primer / cement applicator is crucial to insuring the proper amount of product is applied to the pipe and fittings. The correct applicator is sized by the pipe sizes being joined.



Part No.	Description
814DAUBER.100	1/2" - 3/4" SeaCor® Cap Dauber Qt. Can
814DAUBER.200	3/4" - 1-1/2" SeaCor® Cap Dauber Qt. Can
814DAUBER.300	1-1/2" - 3" SeaCor® Cap Dauber Qt. Can *
814DAUBER.500	3" - 6" SeaCor® Cap Swab Qt. Can

Pipe Cutters and Deburring Chamfer Tools

Wheel type cutters are recommended for the SeaCor system to help ensure a clean pipe cut. Other types of cutters can be used, but may increase the pipe preparation time. Deburring tools are used not only to clean the pipe cut, but also chamfer the pipe to allow the cement to flow properly in the joint as the final pressing is done.



1/2" - 2-1/2"



1-1/2" - 4"

Part No.	Description
814CHAMFER.100	SeaCor Deburring-Chamfer Tool 1/2"-1"
814CHAMFER.250	SeaCor Deburring-Chamfer Tool 1-1/4"-4"
814CUT.100	SeaCor Quick Release Cutting Tool 1-1/2"-4"
814CUT.300	SeaCor Quick Release Cutting Tool 1/2"-2-1/2"
814CHAMFERBLADES.100	Deburring-Chamfer Tool Spare Blades 1/2"-1"
814CHAMFERBLADES.250	Deburring-Chamfer Tool Spare Blades 1-1/4"-4"
814PIPECUTTERWHEEL.300	Cutting Tool 1-1/2"-4" Spare Wheel
814PIPECUTTERWHEEL.100	Cutting Tool 1/2"-2-1/2" Spare Wheel



1/2" - 1" Deburring Tool



1-1/4" - 4" Deburring Tool

SeaCor Piping System Applications		SHIPBOARD LOCATION										
System	Application	Category A Machinery Spaces	Non-Cat A Machinery Spaces	Cargo Pump Rooms	Ro-Ro Cargo Holds	Dry Cargo Holds	Cargo Tanks	Fuel Oil Tanks	Water Tanks	Cofferdams Void Spaces Pipe Tunnels	Accommodation Spaces	Service & Control Spaces
Potable Water Hot & Cold	Hot & Cold Water Supply	YES	YES	YES	YES	NO	NO	NO	NO	YES	YES	YES
Grey & Black Water	Collection, Transfer, Storage	YES	YES	NO	YES	NO	NO	NO	NO	YES	YES	YES
Grey & Black Water	Treatment, Discharge*	YES	YES	NO	NO	NO	NO	NO	NO	YES	YES	YES
Fresh Water Systems	Evaporators, Reverse Osmosis	YES	YES	NO	NO	NO	NO	NO	NO	YES	YES	YES
Secondary Seawater Cooling Systems	Chillers, Heat Exchangers, Non-Essential Cooling/Heating	YES	YES	NO	NO	NO	NO	NO	NO	YES	YES	YES
Secondary Freshwater Cooling Systems	Chillers, Heat Exchangers, Non-Essential Cooling/Heating	YES	YES	NO	NO	NO	NO	NO	NO	YES	YES	YES
Brine	R/O & Evaporator Brine Discharge*	YES	YES	NO	NO	NO	NO	NO	NO	YES	YES	YES
Chemical Injection	Cooling Water Treatment, Biocide & Chlorinators	YES	YES	NO	YES	NO	NO	NO	NO	YES	YES	YES
HVAC Water Circulation	Hot & Cold Circulation, Fan Coil Unit Drains	YES	YES	NO	YES	NO	NO	NO	NO	YES	YES	YES
Salt Water Washdown	Deck, Cargo Hold Washdown	YES	YES	YES	YES	YES	NO	NO	NO	YES	YES	YES
Technical Water	Deck, Cargo Hold, Machinery Space Washdown, General Service Supply	YES	YES	YES	YES	YES	NO	NO	NO	YES	YES	YES
Deck Drains	External Deck Drains on Superstructure	YES	YES	NO	NO	NO	NO	NO	NO	YES	YES	YES
Deck Drains	Internal Deck Drains	YES	YES	NO	NO	YES	NO	NO	YES	YES	YES	YES
Vents & Sounding	In Tank Vent Piping	YES	YES	YES	YES	YES	NO	NO	YES	YES	YES	YES
Vents & Sounding	In Tank Sounding Tube Piping	YES	YES	YES	YES	YES	NO	NO	YES	YES	YES	YES
Ballast	Auxiliary Ballast Piping	NO	NO	NO	NO	NO	NO	NO	YES	YES	NO	NO
Exhaust Gas Scrubbers	Effluent Lines**, NaOH Injection, Sludge Collection & Storage	YES	YES	NO	NO	NO	NO	NO	YES	YES	NO	NO
		* Seachest & OVBD Discharges Must use a metallic valve between SeaCor and the steel shell piping										
		** Effluent Service Temperature Below 210°F (99°C)										
		Note: SeaCor may be used in Other Systems & locations labeled "0" (No fire endurance required) in Table 1										
Systems, Application & Locations are per ABS Fire Endurance Matrix, ABS SVR 4-6-4 Table 1												
SeaCor Cannot be install in Bilge Piping, Fire Mains, Fuel or Cargo Oil Systems, Primary Cooling or other Essential Systems												

Since 1975, W&O has served a variety of worldwide customers in the marine and upstream oil and gas industries. We continuously strive to be an integral part of your supply chain by providing value added consultancy,

Let W&O assist you with your plastic piping needs. To find out more information about SeaCor® and other W&O products, visit wosupply.com or email: seacor@wosupply.com.

LOCATIONS



Alabama

Mobile

4766 Rangeline Road
Mobile, AL 36619
Tel: +1 251.433.2816
mobile.al@wosupply.com

California

San Diego: VAC

2390 Boswell Road, Suite 100
Chula Vista, CA 91914
Tel: +1 619.656.7420
vac@wosupply.com

Florida

Jacksonville - Corp. Office

2677 Port Industrial Drive
Jacksonville, FL 32226
Tel: +1 904.354.3800
corporate@wosupply.com

Ft. Lauderdale

Tel: +1 954.462.8008
ftlauderdale.fl@wosupply.com

Tampa

2810 North 34th Street Tampa,
FL 33605
Tel: +1 813.248.4139
tampa.fl@wosupply.com

Louisiana

New Orleans

4800 River Road
Jefferson, LA 70121
Tel: +1 504.733.6350
neworleans.la@wosupply.com

Houma

547 South Hollywood Road
Houma, LA 70360
Tel: +1 985.772.7010
houma.la@wosupply.com

Pennsylvania

Philadelphia - Sales Office

Tel: +1 610.586.8070
philadelphia.pa@wosupply.com

South Carolina

Charleston

1670 Drydock Ave, Building #9
North Charleston, SC 29405
Tel: +1 843.747.6347
charleston.sc@wosupply.com

Texas

Houston

10025 Porter Road, Suite 100
LaPorte, TX 77571
Tel: +1 832.386.9300
houston.tx@wosupply.com

Virginia

Norfolk

5901 Thurston Ave
Virginia Beach, VA 23455
Tel: +1 757.217.2800
norfolk.va@wosupply.com

Washington

Seattle

9411 8th Ave South, Suite 1
Seattle, WA 98106
Tel: +1 206.223.0584
seattle.wa@wosupply.com

Canada

Vancouver

Tel: +1 604.525.9505
vancouver.bc@wosupply.com

Halifax

133 IIsley Avenue, Unit ST
Dartmouth, NS B3B 1S9
Tel: +1 902.481.7333
halifax@wosupply.com

Europe

Netherlands

Blankenweg 20
4612 RC Bergen op Zoom
Netherlands
Tel: +31 164 212420
sales@woeurope.com

Asia

Singapore

14 Gul Avenue
Singapore 629657
Tel: +65 3163 2986
sales@woasia.com

CHOOSE W&O

- We are there when you need us.
- 40 years as a reputable partner.
- Over \$45 million in inventory.
- Automation experts with in-house design and fabrication.
- We represent top brands with the required certifications and registrations.
- Largest distributor of pipe, valves, fittings and automation.
- Valve services: ship checks and engineered solutions troubleshooting.
- Delivering new technologies and monitoring regulations to better serve our customers.



wosupply.com

July 2022